

# Signal Phone

KSP Series, 41/42/43 Series, 61/62 Series



## Part Number Description

|                                  |   |                        |          |                                |                                      |
|----------------------------------|---|------------------------|----------|--------------------------------|--------------------------------------|
| <b>KSP</b>                       | - | <b>1</b>               | <b>2</b> | <b>3</b>                       | <b>4</b>                             |
| <b>1</b> Sound                   |   | 4 : 4 Sound            |          | 6 : 16 Sound                   |                                      |
| <b>2</b> Supply Voltage          |   | 1 : 110/220VAC 50/60Hz |          | 2 : 12/24VDC                   | 3 : 100 - 125VDC (KSP-4 series only) |
| <b>3</b> KSP-4 Type              |   | S : Melody Variation   |          | T : Beep-Sound Tempo Variation |                                      |
| KSP-6 Type (Speaker Size)        |   | L : □72mm              |          | S : □48mm                      |                                      |
| <b>4</b> Color (KSP-6 Type Only) |   | S : Silver             |          | K : Black                      |                                      |



## General Specification

|                      |                                |                                |
|----------------------|--------------------------------|--------------------------------|
| Size                 | L : □72mm                      | S : □48mm                      |
| Power Consumption    | Max. 5W                        |                                |
| Maximum Sound Level  | 80 - 90dB(Phon) 1m / alterable | 80 - 85dB(Phon) 1m / alterable |
| Life Cycle           | Min. 1,000hrs                  |                                |
| Color                | silver, black                  |                                |
| Ambient Temperature  | -10 - +60°C                    |                                |
| Tightening Torque    | 0.5N·m (5.1kgf·cm)             |                                |
| Degree of Protection | KSP-4 Series : IP65            | KSP-6 Series : IP54            |

Note) In case of S Type speaker, life may be shortened when energized continuously for a long time.

| 41/42/43 Series |                       |                                | 61/62 Series |               |                 |                 |                     |
|-----------------|-----------------------|--------------------------------|--------------|---------------|-----------------|-----------------|---------------------|
|                 | KSP-4□S               | KSP-4□T                        |              | Mode 1(00) ■■ | Mode 2(01) ■■   | Mode 3(10) ■■   | Mode 4(11) ■■       |
| K1              | Ambulance             | Fast tempo ambulance           | K1           | Fast          | Continuous      | Space gun       | Highly intermittent |
| K2              | Patrol                | Slow tempo                     | K2           | Slow          | Intermittent    | Phone ringtone  | Highly continuous   |
| K3              | Telephone             | High tone telephone            | K3           | Do-re-mi      | Ambulance       | School bell     | Splash splash       |
| K4              | 'Stepping stone' song | Low tone 'stepping stone' song | K4           | Jingle bell   | Batter entrance | Stepping stones | Siloam              |

## Product Selection

|   | Description                | 110VAC / 220VAC | 12VDC / 24VDC | 100 - 125VDC |
|---|----------------------------|-----------------|---------------|--------------|
|  | Melody Variation           | KSP - 41S       | KSP - 42S     | KSP - 43S    |
|   | Beep-Sound Tempo Variation | KSP - 41T       | KSP - 42T     | KSP - 43T    |
|  | Small Silver               | KSP - 61SS      | KSP - 62SS    | -            |
|   | Small Black                | KSP - 61SK      | KSP - 62SK    | -            |
|  | Large Silver               | KSP - 61LS      | KSP - 62LS    | -            |
|   | Large Black                | KSP - 61LK      | KSP - 62LK    | -            |

## Dimension

unit : mm

### 41/42/43 Series

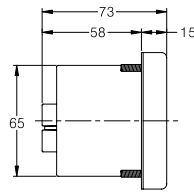
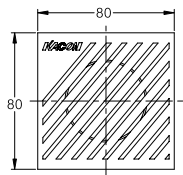

### Mountain Insulation

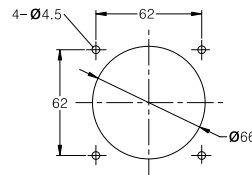

### Wire Diagram

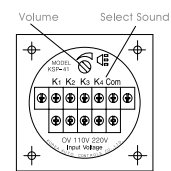

### 61S, 62S Series

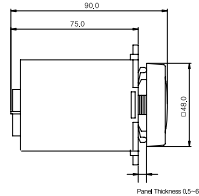

### 61L, 62L Series

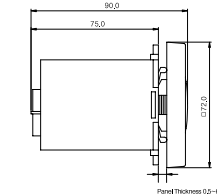

### Mountain Insulation

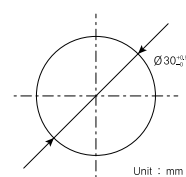

### Wire Diagram

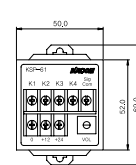

## Accessory

### KSP-Bracket

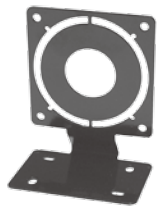

### KSP-C

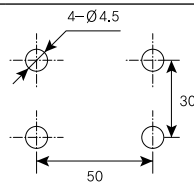

- Bracket (for mounting on the exposed surface)

1

2

3



Insert the front part (speaker) in the panel or bracket

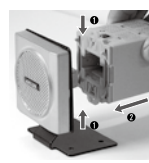

Push the device body in the horizontal arrow direction to attach it to the front part. Push the yellow stopper in the up and down arrow directions to maintain the locking state.



Fully mounted state.  
[Note] Do not apply excessive force for mounting the device in process 2.  
The device may be broken.

### Volume control

The volume can be easily controlled using a small driver.

- Left direction: volume down
- Right direction: volume up

### Sound selection

- Shift the dip switch on the side to the required position (Mode 1 - Mode 4).
- Cut off the input power during the mode setting.

## Caution

1. The signal input circuit of the signal phone has com terminals as follows.
2. Set the tone using relays and switches.

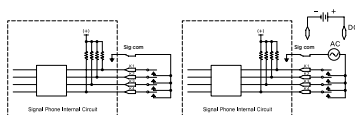

Signal input terminal

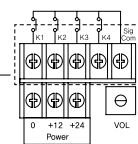

Pay attention to the polarity (+,-) for the DC type (KSP-62). Wrong polarity setting leads to non-operation and damage to the device.

3. Never apply the external power to the signal input terminals (K1, K2, K3, K4 and sig com). It may be the cause of damage to the device.

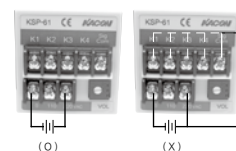

4. Be sure to cut off the input power when resetting the tone mode. Otherwise, an error or abnormal sound may occur.